

FLOORPLAN OPTIONS

We personalise our floorplans. Talk to us about our huge range of ready-to-go design options.

Facades available:

| | |
|----------------------------|---------------|
| Barrine, Mackay, Corella, | |
| Selina, McKenzie | |
| Overall home width | 11.99m |
| Overall home length | 19.07m |

| | | |
|--------------|---------------------------|---------------|
| Residence | 278.8m ² | 30sq |
| Garage | 36.6m ² | 3.9sq |
| Porch | 3.3m ² | 0.4sq |
| Alfresco | 16.8m ² | 1.8sq |
| Total | 335.5m² | 36.1sq |

Listed details based on Barrine facade floorplan (illustrated)

*Copyright conditions. All photos and illustrations are representative only. Floor plans and specifications may be varied by Burbank without notice, the dimensions are diagrammatic only and a Building Contract with final drawings will display correct dimensions and detail. All designs are the property of Burbank and must not be used, reproduced, copied or varied, wholly or in part without written permission from an authorised Burbank representative. Copyright Burbank Australia (NSW) Pty Ltd. ABN 88 610 822 770. NSW BL 295627C ACT BL 2016566.

Call 13 BURBANK
Visit burbank.com.au

OPTION IP1

Provide 1no. 2400mm x 3010mm and 1no. 2400mm x 2410mm timber clear finish bi-fold doors to Family/Meals in lieu of standard.

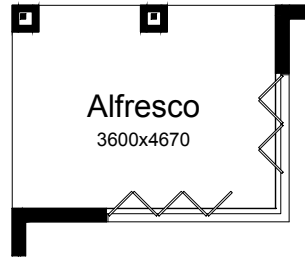

OPTION EP1

Provide extension to Alfresco adjoining Meals including Retreat to Bed 1 and Balcony with stainless steel framed glass balustrading with roof over to first floor in lieu of standard. Provide 2100mm x 1810mm sliding door to Balcony, 1800mm x 1810mm aluminium sliding window to Retreat in lieu of 1800mm x 850mm aluminium sliding window to Bed 1. Increases area by 37.03m². Increases length by 3000mm.

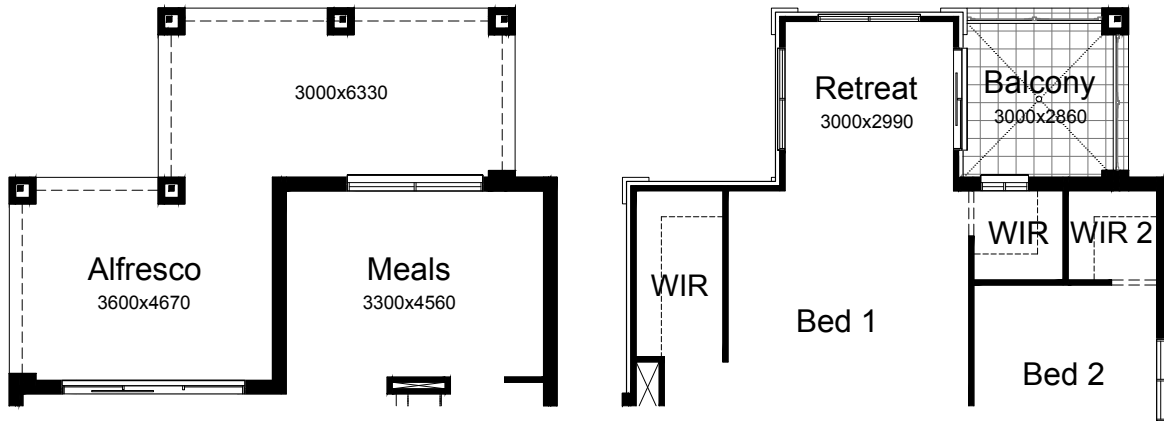

OPTION ENS1

Provide Ensuite upgrade including additional 1675mm bath with tiled hob, 1no. 1582mm wide vanity unit with double bowls in lieu of standard 1782mm wide vanity unit and 1no. 1800mm x 610mm aluminium awning window in lieu of standard 1no. 1027mm x 1450mm aluminium sliding window and relocate 900x900mm tiled shower base

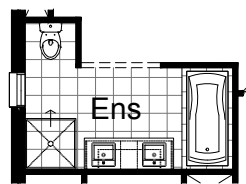

OPTION ENS2

Option ENS2
Provide Ensuite upgrade including wall to wall tiled shower base in lieu of standard and double bowls to vanity unit

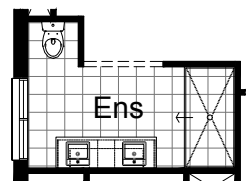

OPTION K1

Provide Kitchen upgrade with 1no. 400mm laminated tall pantry, 1no. 900mm laminated tall pantry, laminated open shelf above refrigerator space, 3no. 900mm base cupboards, 1no. laminated DW provision, 2no. 300mm base cupboards, 1no. 350mm base cupboard, 2no. 300mm laminated overhead open shelf unit, 3no. 900mm overhead cupboards, 2no. laminated wall oven/ MW towers, 1no. 450mm drawers, 1no. 900mm cooktop with retractable rangehood concealed within overhead cupboard, 1no. 480mm wide x 1020mm high plaster lined wall cut out. Alter tiled splash back and bench top to suit.

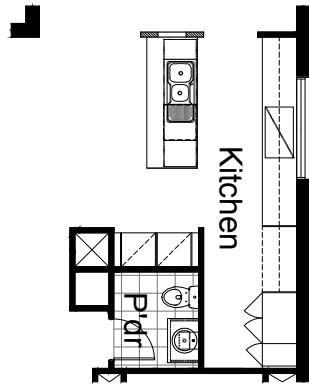

OPTION G3

Provide triple car Garage including additional roller door to front. (Option available to Facades with hip roof over Garage). Increases area by 23.61m². Increases width by 3600mm.

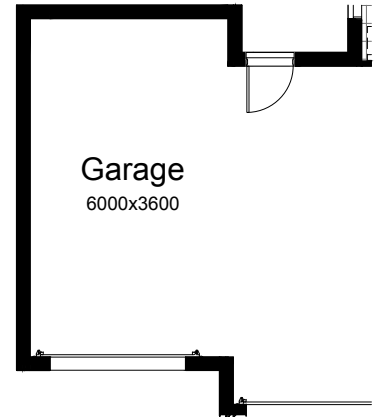

OPTION LD1

Provide Laundry upgrade including laminated insert trough, 1no. 900mm base cupboard, 3no. 400mm base cupboards, 1no. 800mm base cupboard, 1no. 900mm overhead cupboard, 3no. 400mm overhead cupboards, 1no. 800mm laminated open shelf with hanging rail and additional bench top and tiled splash back to suit.

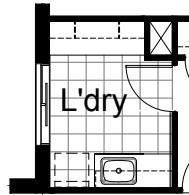

OPTION IP2

Provide Jetmaster SL-350 gas fireplace, 400mm off floor level in a 1400mm x 420mm boxed out plaster wall with a 4 sided black fascia to Family room side wall with 2no. 1800mm x 850mm aluminium sliding windows in lieu of standard 1no. 1800mm x 2400mm window.

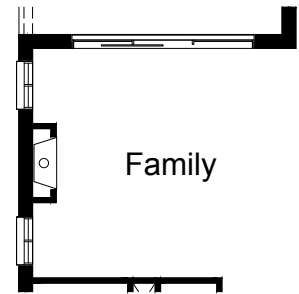

OPTION G1

Provide extension to Garage to create additional Storage area. (Option available to Facades with hip roof over Garage). Increases area by 4.58m². Increases width by 850mm.



OPTION G2

Provide extension to Garage to create Workshop area including additional window to suit. (Option available to Facades with hip roof over Garage). Increases area by 13.51m². Increases width by 2400mm.

